

KEY:

REPLACE TIMBER BOARDS TO THREE FACES OF LANTERN ROOF WITH COLORBOND STEEL OR WRC TO MATCH EXISTING:

1.

 - COLOUR "WOODLAND GREY" (ORIGINAL "SLATE GREY")

2.

 - COLOUR "GULLY" OR "JASPER" TO BEST MATCH WEATHERED STATE OF EXISTING ROOF (ORIGINAL "WEATHERED COPPER")

FACADE TO BE INSPECTED AND DMAGED BOARDS TO BE REPLACED WITH BUSHFIRE SUITABLE TIMBER BOARDS OR WRC IN PROFILE TO MATCH EXISTING CEDAR

BALCONIES:

- REPLACE DECKING BOARDS AND DECK FASCIA

- DECKING STAIN TO BE CABOTS HACIENDA GREY (OPTIONAL)

UNDERFLOOR:

- REPAIR DAMAGED INSULATION AND BUILDING WRAP AND INSTALL FC LINING WITH FC JOINING STRIP. CUT AROUND SERVICES AS IS PRACTICAL

- INSTALL SAME TO REMAINING CABINS AS A PREVENTATIVE MEASURE

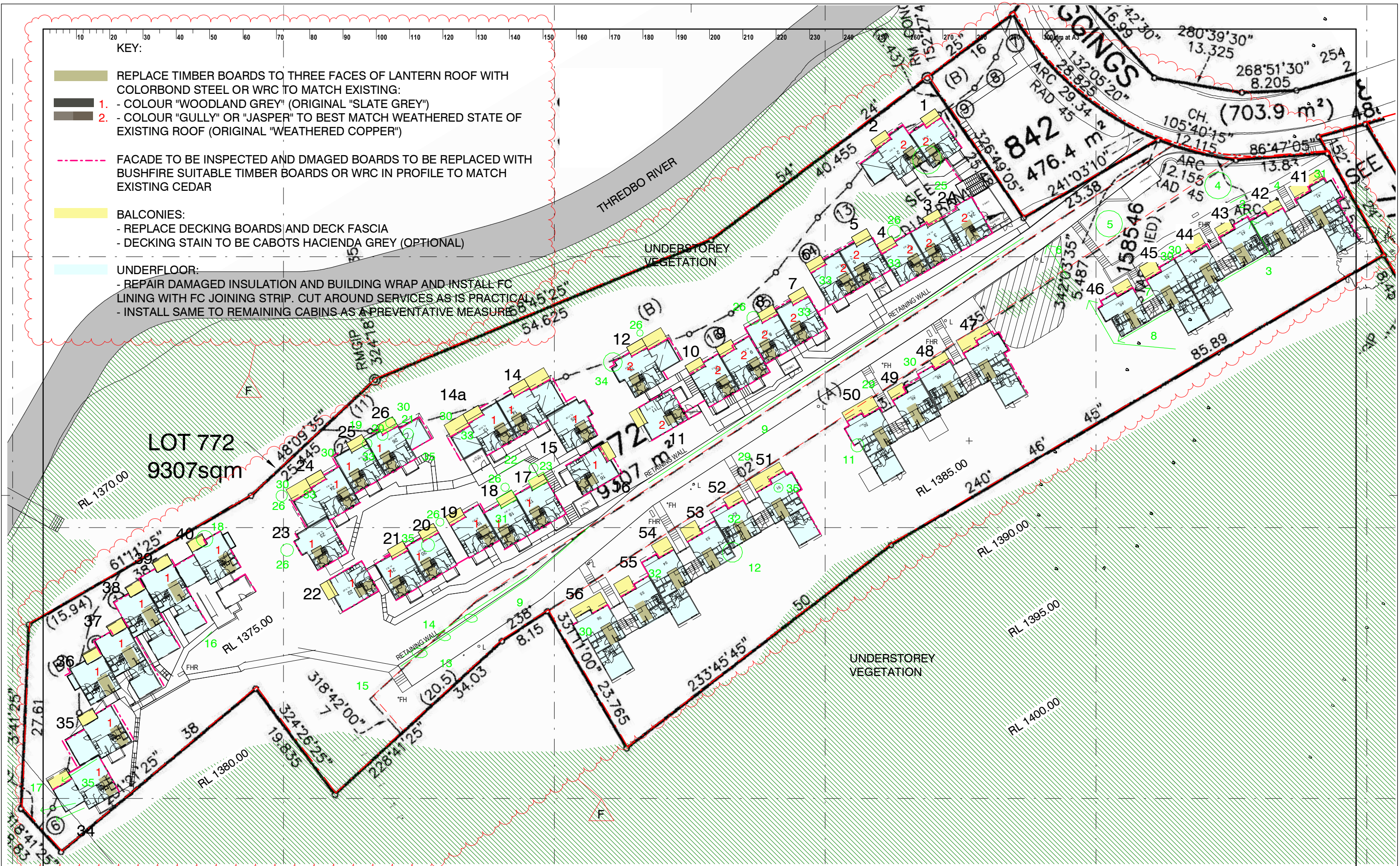

ISSUE	DATE	SUBJECT	AUTHORISED
A	02/06/20	INITIAL ISSUE FOR COMMENT	ST
B	03/07/20	SCOPE REVISED	ARH
C	17/08/20	SOFFIT LINING ADDED	ARH
D	18/08/20	DECK SCOPE AMENDED	ST
E	02/11/20	VEGETATION EDGE ADDED	ARH
F	12/10/21	SITE DATA ADDED	ARH

DEVELOPMENT APPLICATION

This drawing should be read in conjunction with all relevant contracts, specifications and drawings. Dimensions are in millimetres. Levels are metres. Do not scale off drawings. Use figured dimensions only. Check dimensions on Site. Report discrepancies immediately.

TRUE NORTH

PROJECT NORTH

PROJECT

RIVERSIDE CABINS MAINTENANCE

DIGGINGS TERRACE

THREDBO VILLAGE

CLIENT

RIVERSIDE CABINS

AUTHORISED FOR ISSUE

13/09/23

DIRECTOR

DATE

ARCHITECT

djrd

architects

T + 612 9319 2955
ABN: 48 942 921 969
Nominated Architects:
Andrew Hipwell 6562
Daniel Beekwilder 6192

63 Myrtle Street
Chippendale NSW 2008
Sydney Australia
djrd.com.au

DRAWN	SCALE AT A3	ISSUE DATE
Author	1:500	12/10/21
DESCRIPTION		
SITE PLAN SHEET 2		
PROJECT No	DRAWING No	REVISION
20411	A0.102	F